

ITEM #: _____ QUANTITY: _____
MODEL #: _____
PROJECT NAME: _____



EUROBAR PRE-CONFIGURED MODELS

MODEL NUMBERS

EBPCU75 | EuroBar Pre-Configured Model 75"

EBPCU78 | EuroBar Pre-Configured Model 78"

EBPCU84 | EuroBar Pre-Configured Model 84"

FEATURES

- Pre-configured models available in three different sizes (75", 78", 84")
- Models include main station, iced juice well, ice bin, and blender station dump sink
- Ergonomic design for maximum efficiency
- Improved sanitation and food safety standards due to ice bin positioning
- Central workstation with ample storage across the lineup
- Quality construction: 304 Stainless steel with 14ga Top/18ga Cabinet body
- Made in the USA; NSF Approved

ACCESSORIES (OPTIONAL)

- Under bar Liquor Display
- Blender Station with Dump Sink
- POS Station
- Trash Bin Cabinet
- Soda Gun Filler Section
- Spice Caddy
- Hand Sink

BUILD YOUR EUROBAR

- Customize your EuroBar with a variety of modules and accessories at www.eurobarstation.com/resources



EBPCU75



EBPCU78



EBPCU84



EUROBAR PRE-CONFIGURED SPECIFICATION SHEET

ITEM #: _____ QUANTITY: _____
 MODEL #: _____
 PROJECT NAME: _____



EUROBAR PRE-CONFIGURED MODELS

SPECIFICATIONS

| Model | Dimensions | Juice Well Capacity | Juice Well Drawer Capacity | Speed Rail Capacity | Ice Bin Size | Trash Can Capacity |
|---------|-------------|---------------------|----------------------------|---------------------|--------------|--------------------|
| EBPCU75 | 75"x24"x36" | 6 Bottles | 5 Bottles | 4 Bottles | 15" | 10 Gallon |
| EBPCU78 | 78"x24"x36" | 6 Bottles | 5 Bottles | 5 Bottles | 18" | 10 Gallon |
| EBPCU84 | 84"x24"x36" | 6 Bottles | 5 Bottles | 6 Bottles | 24" | 10 Gallon |

DIMENSIONS

EBPCU75

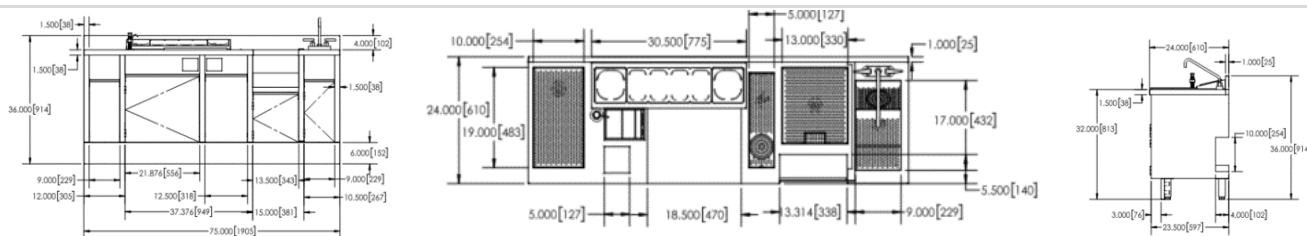

EBPCU78

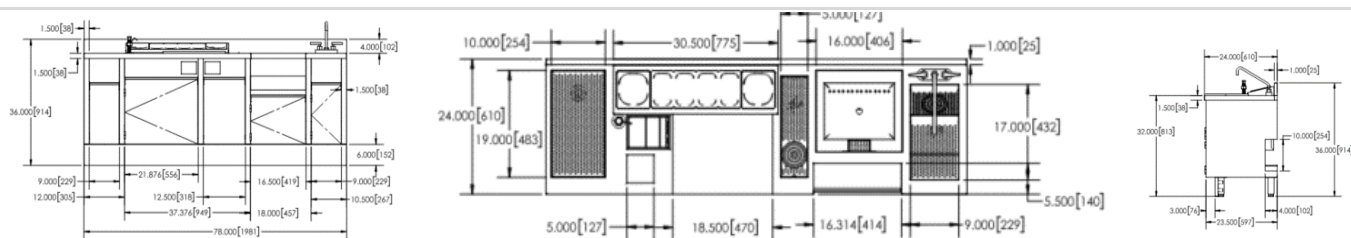

EBPCU84

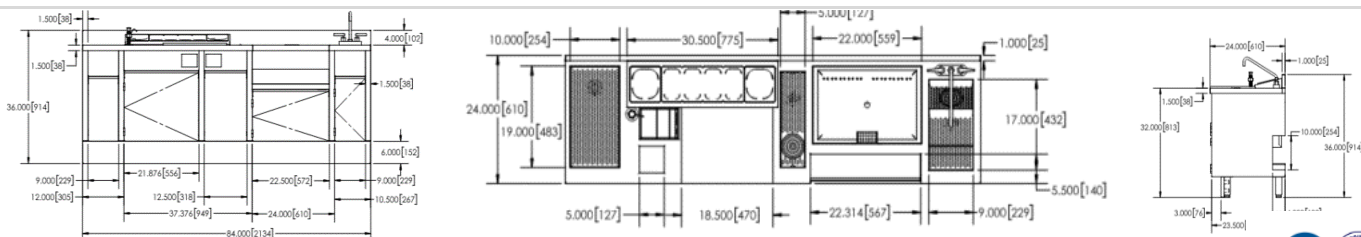

EUROBAR PRE-CONFIGURED SPECIFICATION SHEET